

PHF TB1210X28MM

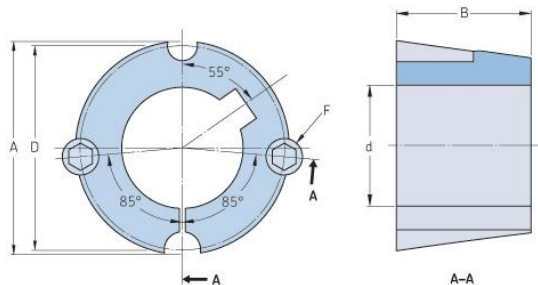

| | |
|------------------------|----------------|
| Bushing no. | TB1210 |
| d = Bore diameter (mm) | 28 |
| Bore diameter (in) | 1.1 |
| Keyway width (mm) | 8 |
| Keyway width (in) | 0.31 |
| Keyway depth (mm) | 3.3 |
| Keyway depth (in) | 0.13 |
| A (mm) | 47.6 |
| A (in) | 1.87 |
| B (mm) | 25.4 |
| B (in) | 1 |
| D (mm) | 44.5 |
| D (in) | 1.75 |
| E (mm) | - |
| E (in) | - |
| F (mm) | 9.525 x 15.875 |
| F (in) | - |
| Weight (kg) | 0.16 |
| Weight (lbs) | 0.35 |